

SSA-S TYPE



There are some non-conforming products.



Swivel



Angle type



Equipped with a single stopper



Double bearing

- Equipped with a pedal type single stopper

● Description of product number

SSA - 75 RH S

Bracket type
Wheel diameter
Wheel type
Equipped with stopper

(* "S" indicates that a stopper is equipped. If wheel type is NRB or UHF, please describe "DS".)



SA-75RHS



SA-100WS

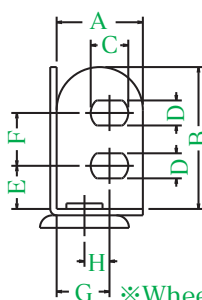
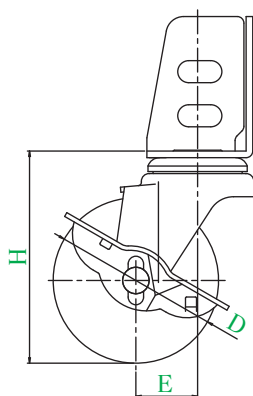

※Wheel diameter: 50

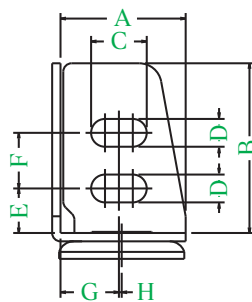

※Wheel diameter: 65 to 100

Wheel in use

Wheel diameter: $\phi 50$ to $\phi 75$



R RH
Rubber wheel



NR
Rubber wheel with nylon wheel assembly



NRB
Rubber wheel with nylon wheel assembly (including B)



N
Nylon wheel

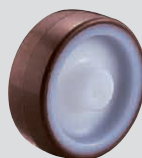

UR
Urethane wheel with nylon wheel assembly



UHF
Urethane wheel with nylon wheel assembly (including B)







EL
Elastomer wheel

Table of specifications of angle

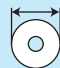
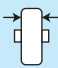
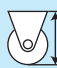
Wheel diameter	A	B	C	D	E	F	G	H
(mm)	(mm)	(mm)	(mm)	(mm)	(mm)	(mm)	(mm)	(mm)
50	31	51	13.5	9	15.5	19	19	4
65	45	61	20	10	16	20	21	1
75								
100								

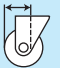
Bracket = Trivalent unichrome coating

Product number			Wheels							
				Wheel diameter	Wheel width	Mounting height	Eccentricity	Turning radius	Allowance load	Wheel weight
				D(mm)	W(mm)	H(mm)	E(mm)	R(mm)	daN(kgf)	(g)
SSA-50	R	S	Rubber wheel	50	20	65	22	49	30(30.6)	210
	N		Nylon wheel		21				40(40.8)	185
SSA-65	RH	S	Rubber wheel	65	25	88	27	68	50(51.0)	520
	N		Nylon wheel						60(61.2)	470
	UR		Urethane wheel with nylon wheel assembly		27				60(61.2)	480
	EL		Elastomer wheel						40(40.8)	480
SSA-75	RH	S	Rubber wheel	75	25	96	28	68	60(61.2)	560
	NR		Rubber wheel with nylon wheel assembly		27				60(61.2)	505
	NRB	DS	Rubber wheel with nylon wheel assembly (including B)		70			60(61.2)	545	
	N	S	Nylon wheel		25			68	60(61.2)	465
	UR		Urethane wheel with nylon wheel assembly						60(61.2)	500
	UHF	DS	Urethane wheel with nylon wheel assembly (including B)		70			60(61.2)	540	
	EL	S	Elastomer wheel		68			50(51.0)	500	
SSA-100	W	S	Rubber wheel with steel plate wheel assembly (including B)	100	32	132	32	86	90(91.8)	1050
	WP		Rubber wheel with steel plate wheel assembly						90(91.8)	1000
	NR		Rubber wheel with nylon wheel assembly (including B)						90(91.8)	935
	N		Nylon wheel						90(91.8)	850
	NB		Nylon wheel (including B)						90(91.8)	945
	UW		Urethane wheel with steel plate wheel assembly (including B)						90(91.8)	1140
	GU		Urethane wheel with nylon wheel assembly (including B)						90(91.8)	950

- These casters are used for only locking rotation of the wheel.
- Conductive rubber wheel can be manufactured.
- The antistatic urethane wheel assembly (including B) having a wheel diameter of ϕ 100 can be manufactured.
- For nylon wheels having a wheel diameter of ϕ 50 to ϕ 75, black wheels can be manufactured.

Wheel in use

Wheel diameter: ϕ 100

Refer to P158 for detailed specifications.

