

REV.	MODIFICATION.	DATE	DRN
01	PRODUCTION RELEASE	02/02/16	SFH

Catch

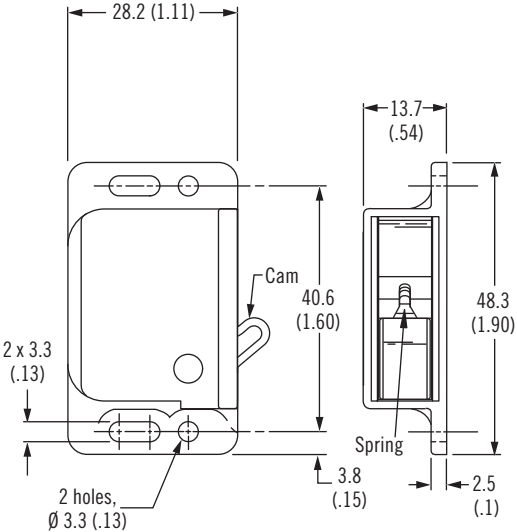

Keeper

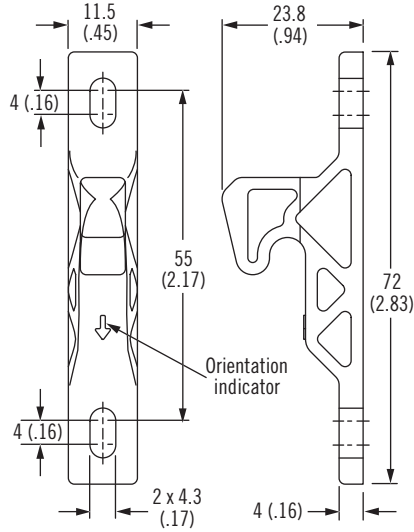

TYPICAL APPLICATION DIAGRAM

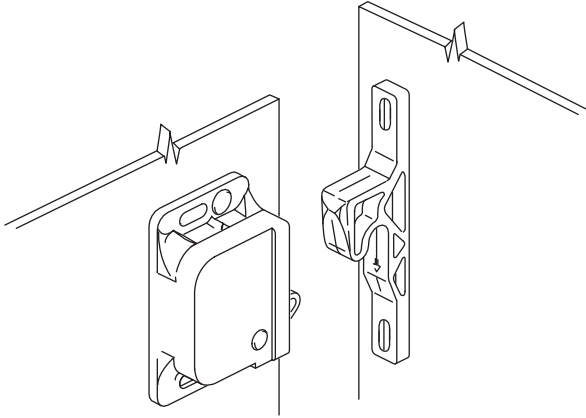

Article Number	Spring force
SC3-805	20N
SC3-803	10N
Catch and keeper are sold as whole set.	

NOTES

1. MATERIAL PA66,BLACK
2. MAX.TIGHTING TORQUE ON SCREW FOR CATCH:1.1NM AND 2.7NM FOR KEEPER.
3. WORKING TEMPERATURE MIN -30°C MAX 80 °C
4. PULL TO OPEN, PUSH TO CLOSE

MATERIAL: SEE TABLE		COLOUR: SEE TABLE		PART No: SEE TABLE	
DRG No: GRAB30235		PROJECT NUMBER: EU12-0020		Mass:(g)	SHEET SIZE A4
DRN SFH	DATE 03/02/12	CHKD TC	DATE 03/02/12	SCALE NTS	SHEET No. 1 OF 1